

# Designated Accommodation for Short-Term International Students

## 1. Name and Address

### Female dormitory: Dormy Hirai 2 (ドーミー平井2)

Address: 4-25-2 Hirai, Edogawa-ku, Tokyo 132-0035 Japan

〒132-0035 東京都江戸川区平井 4-25-2

The nearest station : Hirai station(JR Sobu-Line)

Telephone (Superintendent): +81-3-5836-7130

Fax (Superintendent): +81-3-6685-1873

## 2. Common/Shared Facilities

Dining room, kitchen, public bath, washing machine,  
Drying machine (paid), bike-parking lot, TV, refrigerator,  
Microwave

## 3. Individual Facilities (in each room) Room size: approx. 9.02 m<sup>2</sup>

Air-conditioner, bed, desk, chair, lighting (room, desk),  
Closet, bookshelf, Wi-Fi, TV-outlet,

e.g.

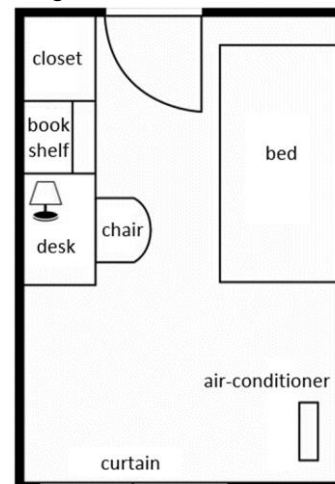

## 4. Fees (tax included)

1) Rent (administration fee included) 家賃

Exchange Student: 277,200 JPY / 6 months; 554,400 JPY / year

Visiting International students (Fee paying): 427,200 JPY / 6 months; 854,400 JPY / year

\*Exchange student will be subsidized 25,000JPY/month for rent of dormitory.

\*Breakfast and evening meals are provided. (Except on Sundays and national holidays)

2) Bedding rental 寝具レンタル

12,980 JPY / 3 month, 18,920 JPY / 6 months, 30,800 JPY / year

3) Utilities (electricity, gas and water) 光熱水費 \*Subsidized by Hosei University

4) Internet basic charge インターネット基本料金

3,960 JPY / month (Fixed monthly charge)

Costs may slightly vary according to the revised contract between Hosei University and the management company."Kyoritsu".

## 5. Commuting

About 40 minutes to Ichigaya campus by train and walk.

(Students are responsible for commuting fee. It costs around 4,000 to 5,000 JPY a month)

定期券 : 1 ヶ月約 4,000 円~5,000 円

Hirai to lidabashi by JR Sobu Line: 18-20 minutes (Direct)

JR 総武線 平井⇄飯田橋 18-20 分 (直通)

## Photo Gallery of Dormy Hirai 2

< 外観 External appearance >



< 食堂 Dining room >



< 食堂 Dining room >



<キッチン Kitchen >



< ランドリー Laundry >



< 浴室 Public bath >



< 浴室内シャワー Shower room in public bath >



< 管理人室 Dorm manager's office >



< ラウンジ Lounge >



< 部屋 Room >



< 寮の屋上からの眺望 View from rooftop >

