

Designated Accommodation for ESOP Students

1. Name and Address

Female dormitory: Dormy Hirai 2 (ドーマー平井2)

Address: 4-25-2 Hirai, Edogawa-ku, Tokyo 132-0035 Japan

〒132-0035 東京都江戸川区平井 4-25-2

The nearest station : Hirai station(JR Sobu-Line)

Telephone (Superintendent): +81-3-5836-7130

2. Common/Shared Facilities

Dining room, kitchen, public bath, washing machine,
Drying machine (paid), bike-parking lot, TV, refrigerator,
Microwave

3. Individual Facilities (in each room) Room size: approx. 9.02 m²

Air-conditioner, bed, desk, chair, lighting (room, desk),
Closet, bookshelf, Wi-Fi, TV-outlet,

e.g.

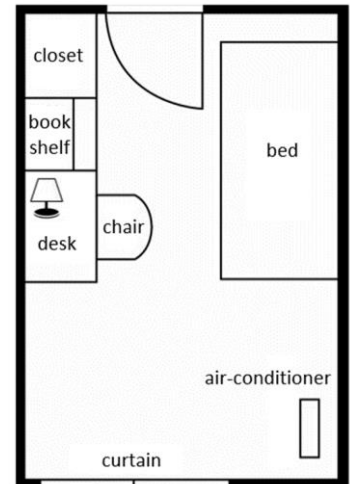

4. Fees (tax included)

1) Rent (administration fee included) 家賃

Exchange Student: 277,200 JPY / 6 months, 554,400 JPY / year

Visiting International students (Fee paying): 427,200 JPY / 6 months, 854,400 JPY / year

*Exchange student will be subsidized 25,000JPY/month for rent of dormitory.

*Breakfast and evening meals are provided. (Except on Sundays and national holidays)

2) Bedding rental 寝具レンタル *Optional

20,020 JPY / 6 months, 31,900 JPY / year

3) Utilities (electricity, gas and water) 水道光熱費 *Subsidized by Hosei University

4) Internet basic charge インターネット基本料金

3,960 JPY / month (Fixed monthly charge)

Costs may slightly vary according to the revised contract between Hosei University and the management company "Kyoritsu".

5. Commuting

About 40 minutes to Ichigaya campus by train and walk.

(Students are responsible for commuting fee. It costs around 4,000 to 5,000 JPY a month)

定期券 : 1 ヶ月約 4,000 円~5,000 円

Hirai to Iidabashi by JR Sobu Line: 18-20 minutes (Direct)

JR 総武線 平井⇄飯田橋 18-20 分 (直通)

Photo Gallery of Dormy Hirai 2

< 外観 External appearance >



< 食堂 Dining room >



< 食堂 Dining room >



<キッチン Kitchen >



< ランドリー Laundry >



< 浴室 Public bath >



< 浴室内シャワー Shower room in public bath >



< 管理人室 Dorm manager's office >



< ラウンジ Lounge >



< 部屋 Room >



< 寮の屋上からの眺望 View from rooftop >

